

Residential / Builder Molded Wood Seats Designed for Fashion, Comfort, Luxury and Durability.

by:

PLUMBTECH™



Model 106 Elongated



Model 105 Round

2

Two Year Limited Warranty!

What Is The Need and Opportunity for Residential/Builder Grade Molded Wood Seats?

- Consumer and contractor demand is still in high with a strong preference for molded wood toilet seats in North America.
- In the last 15-20 years the average consumer's ideal price point for a good quality seat has increased from \$15-20 to \$30-60.
- Our market surveys indicate as much as 50% of new home owners are replacing the toilet seats that were installed by the building contractor within weeks of purchasing the home, with a premium seat.
- Consumers are demanding better quality seats and upgrade features. The overwhelming majority of these premium seats are purchased in retail stores.
- Residential/Builder grade molded wood seats provide a crossover that meets the expectations of both homeowners, and builders.
- The goal is to provide Plumbing Wholesalers with a premium molded wood seat, with features that consumers and contractors demand, at a competitive advantage.

PLUMBTECH™



PLUMBTECH Model 106-00
Elongated Molded Wood Seat.
Suggested List: \$33.00



PLUMBTECH Model 105-00
Round Front Molded Wood Seat.
Suggested List: \$24.00

6 Layers
of Finish

1 Sealer
1 Primer
4 Paint



Features and Benefits of PLUMBTECH Models 105 & 106

- **Strong & Durable - Premium quality molded wood.**
- **Six layers of paint finish with sealer and primer.**
- **Maximum level of resins to create a rock hard wood core and extended life.**
- **Assembled with corrosion resistant stainless steel screws.**
- **Release 'N' Clean™ hinges for fast, easy installation and removal for cleaning.**
- **Vari-adjust™ with Lok-Down™ adjustable hinges for a perfect, secure fit on any standard ANSI toilet bowl.**
- **Ergonomically designed seat ring with contour provides greater comfort and support.**
- **Four bumpers on seat ring for extra stability.**
- **Heavy duty contractor grade hinge.**
- **Non-skid rubberized hinge pads.**
- **Corrosion proof Quik-Lok™ POM nuts, bolts and washers.**
- **Easy, self aligning, top mount installation with Quik Lok™ hardware.**
- **UV Ingredient to maintain color**
- **Meets and exceeds ANSI Quality Standards**

“Why pay the same or more, for less quality and features?”

Quik-Lok™



- UP TO 6X FASTER INSTALLATION!
- Save 50% to 80% in time-LABOR COST.
- Increased productivity - install in less than a minute.

 No tools necessary for installation!

Simple Fast Easy

STA-PUT™



Stop the Movement of Seats



- Micro-suction cups inhibit the movement of wood toilet seats during normal use.
- Even minimizes the movement of the cover when the bathroom toilet is being used as a chair.

Vari-Adjust™ with Lok-Down™ Adjustable Hinges and Release N Clean™



Compression
“Dots” lock
seat in place
for added
stability.



Model 105 is available in White.
Model 106 is available in White and Linen/Biscuit..

Plumbing Technologies LLC, plumbtechseats.com
Email: customerservice@plumbtechseats.com Phone: 973-998-9778
Fax: 973-998-9780 or 973-947-6458

RESIDENTIAL MOLDED WOOD



Factory-installed hinge
with stainless steel screws

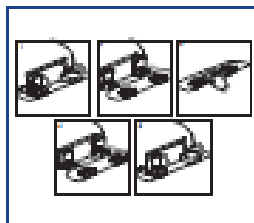

Release 'N' Clean™

Seat shall be PLUMBTECH™ MODEL - 105

- Builder Grade durable molded wood
- Round closed front with cover
- Multi-coat high gloss enamel paint with sealer and primer
- UV paint color protection
- Contractor quality adjustable Release 'N' Clean™ top mount hinge
- Color matching hinge and bumpers
- Four bumpers on ring for stability
- Non-skid rubberized pads
- Assembled with corrosion resistant stainless steel screws
- Corrosion proof POM nuts and bolts
- Specify white -00

PRODUCT SPECIFICATIONS

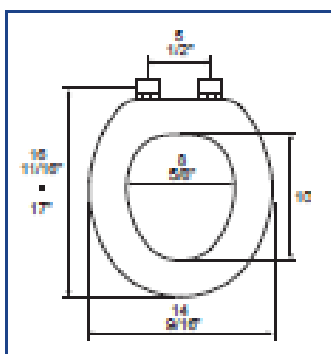

Residential

Model 105 - For ANSI Standard Round Front Toilets

Style: Closed Front with Cover

Material: Molded Wood (wood flour and resin)

Hinge: Heavy Duty Plastic Hinge with Stainless Steel Screws

Height of seat: 2 1/4"

Ring Thickness: 3/4"

Ring Thickness with Bumpers: 1 1/8"

PLUMBTECH™ molded wood seats utilize the finest paint to seal and beautify the molded wood core with deep lustrous color and rock hard enamel durability.

RESIDENTIAL MOLDED WOOD



Factory-installed hinge
with stainless steel screws

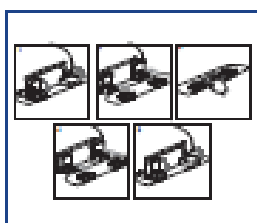

Release 'N' Clean™

Seat shall be PLUMBTECH™ MODEL - 106

- Builder Grade durable molded wood
- Elongated closed front with cover
- Multi-coat high gloss enamel paint with sealer and primer
- UV paint color protection
- Contractor quality adjustable Release 'N' Clean™ top mount hinge
- Color matching hinge and bumpers
- Four bumpers on ring for stability
- Non-skid rubberized pads
- Assembled with corrosion resistant stainless steel screws
- Corrosion proof POM nuts and bolts
- Specify white -00, Biscuit/Linen -02

PRODUCT SPECIFICATIONS

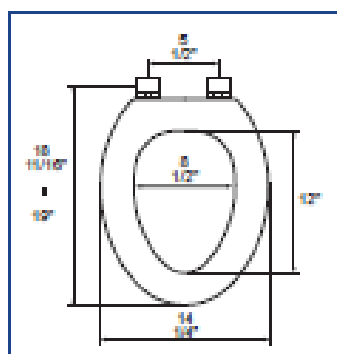

Residential

Model 106 - For ANSI Standard Elongated Front Toilets

Style: Closed Front with Cover

Material: Molded Wood (wood flour and resin)

Hinge: Heavy Duty Plastic Hinge with Stainless Steel Screws

Height of seat: 2 1/4"

Ring Thickness: 3/4"

Ring Thickness with Bumpers: 1 1/8"

PLUMBTECH™ molded wood seats utilize the finest paint to seal and beautify the molded wood core with deep lustrous color and rock hard enamel durability.