

**Premium Wood Seats designed
for fashion, comfort, luxury and
durability.**

by:

PLUMBTECH™



Model 126 Elongated



Model 125 Round



What Is The Need and Opportunity for Premium Molded Wood Seats?

- Consumer demand is still in excess of 60% for molded wood toilet seats in North America.
- In the last 15-20 years the average consumer's ideal price point for a good quality seat has increased from \$15-20 to \$30-40.
- Our market surveys indicate as much as 50% of new home owners are replacing the toilet seats that were installed by the building contractor within weeks of purchasing the home, with a premium seat.
- Consumers are demanding better quality seats and upgrade features. The overwhelming majority of these premium seats are purchased in retail stores.
- The goal is to provide Plumbing Wholesalers with a premium molded wood seat, with features that consumers and contractors demand, at a competitive advantage.

PLUMBTECH™



PLUMBTECH Model
126-00
Premium Elongated
Molded Wood Seat.
Suggested List: \$33.00



PLUMBTECH Model
125-00
Premium Round Front
Molded Wood Seat.
Suggested List: \$23.00

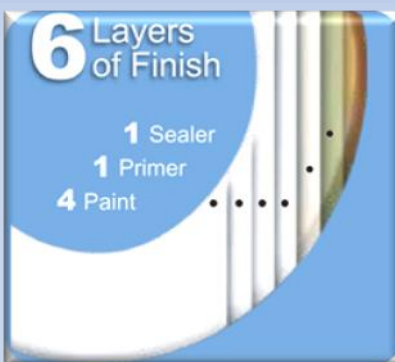

3

Three Year Limited Warranty!

Features and Benefits of PLUMBTECH Models 125 & 126

- **Strong & Durable - Premium quality molded wood.**
- **Six layers of paint finish with sealer and primer.**
- **Maximum level of resins to create a rock hard wood core and extended life.**
- **Steel hinge pintel for long service life.**
- **Assembled with corrosion resistant stainless steel screws.**
- **Release 'N' Clean™ hinges for fast, easy installation and removal for cleaning.**
- **Vari-adjust™ with Lok-Down™ adjustable hinges for a perfect, secure fit on any standard ANSI toilet bowl.**
- **OSG - Odor Stain Guard ingredient in paint**
- **Ergonomically designed seat ring with contour provides greater comfort and support.**
- **Four bumpers on seat ring for extra stability.**
- **Heavy duty contractor grade hinge.**
- **Non-skid rubberized hinge pads.**
- **Corrosion proof Quik-Lok™ POM nuts, bolts and washers.**
- **Easy, self aligning, top mount installation with Quik Lok™ hardware.**
- **UV Ingredient to maintain color**
- **Meets and exceeds ANSI Quality Standards**

“Why pay the same or more, for less quality and features?”

Quik-Lok™



- UP TO 6X FASTER INSTALLATION!
- Save 50% to 80% in time-LABOR COST.
- Increased productivity - install in less than a minute.

 No tools necessary for installation!

Simple Fast Easy

STA-PUT™



Stop the Movement of Seats



- Micro-suction cups inhibit the movement of wood toilet seats during normal use.
- Even minimizes the movement of the cover when the bathroom toilet is being used as a chair.

Vari-Adjust™ with Lok-Down™ Adjustable Hinges and Release N Clean™



Compression
“Dots” lock
seat in place
for added
stability.

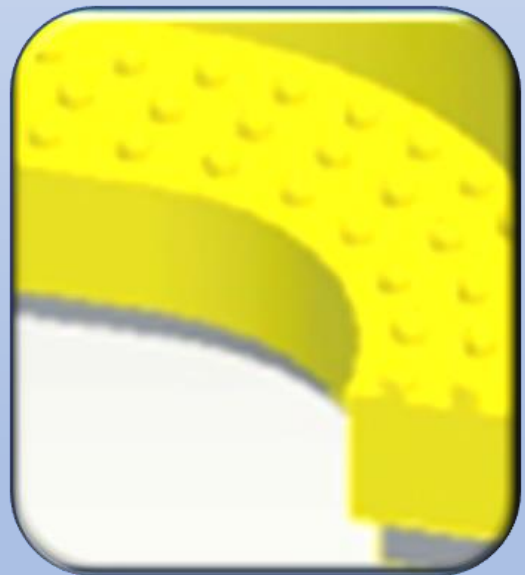

Models 125/126 are available in the following colors:

White, Bone, Linen, Cotton White, Almond, Pink, Beige, Gold, Black, two shades of Blue
and two shades of Gray

Plumbing Technologies LLC, plumbtechseats.com

Email: customerservice@plumbtechseats.com Phone: 973-998-9778

Fax: 973-998-9780 or 973-947-6458

RESIDENTIAL MOLDED WOOD

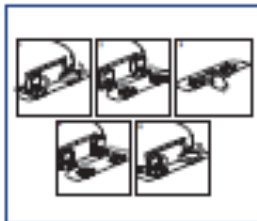
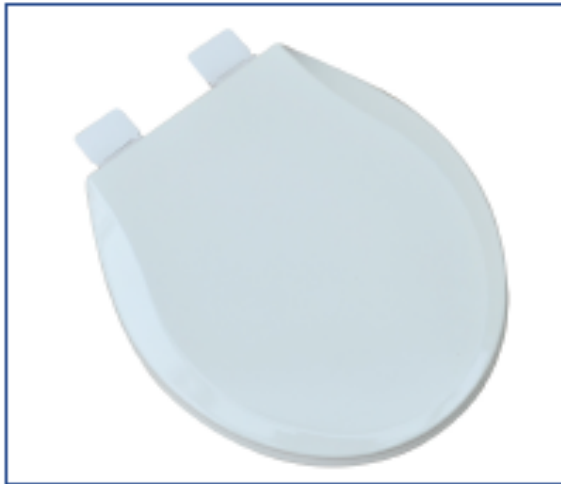

Release 'N' Clean™



Factory-installed "living" hinge covers with stainless steel screws

Seat shall be PLUMBTECH™ MODEL - 125

- Round closed front with cover
- Premium quality durable molded wood
- Multi-coat high gloss enamel paint with sealer and primer
- UV paint color protection
- OSG - Odor Stain Guard ingredient in paint
- Color coordinated hinge with steel pintel
- Four bumpers on ring for stability
- Non-skid rubberized pads
- Assembled with corrosion resistant stainless steel screws
- Corrosion proof POM nuts and bolts
- Contractor quality Release 'N' Clean™ adjustable top mount hinge
- Vari-adjust™ with Lok-Down™ hinge
- Color coordinated bumpers
- Specify white -00, bone -01, biscuit -02, cotton white -04 and select colors

White and select colors available in BathDécor™ package - Model 1C3R3

PRODUCT SPECIFICATIONS

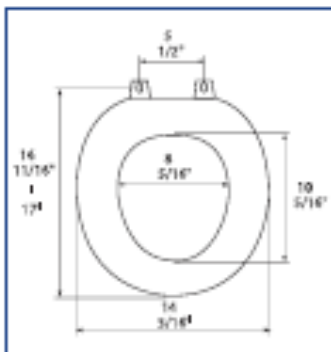

Residential

Model 125 - For ANSI Standard Round Front Toilets

Style: Closed Front with Cover

Material: Molded Wood (wood flour and resin)

Hinge: Extra Heavy Duty Plastic Hinge with Stainless Steel Screws and Pintels

Height of seat: 2 1/4"

Ring Thickness: 7/8"

Ring Thickness with Bumpers: 1 1/8"

PLUMBTECH™ molded wood seats utilize the finest paint to seal and beautify the molded wood core with deep lustrous color and rock hard enamel durability.

RESIDENTIAL MOLDED WOOD

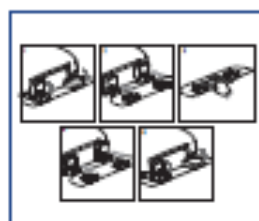

Release 'N' Clean™



Factory-installed "living" hinge covers with stainless steel screws

Seat shall be PLUMBTECH™ MODEL - 126

- Elongated closed front with cover
- Premium quality durable molded wood
- Multi-coat high gloss enamel paint with sealer and primer
- UV paint color protection
- OSG - Odor Stain Guard ingredient in paint
- Color coordinated hinge with steel pintel
- Four bumpers on ring for stability
- Non-skid rubberized pads
- Assembled with corrosion resistant stainless steel screws
- Corrosion proof POM nuts and bolts
- Contractor quality Release 'N' Clean™ adjustable top mount hinge
- Vari-adjust™ with Lok-Down™ hinge
- Color coordinated bumpers
- Specify white -00, bone -01, biscuit -02, cotton white -04 and select colors

White and select colors available in BathDécor™ package - Model 1C3E3

PRODUCT SPECIFICATIONS

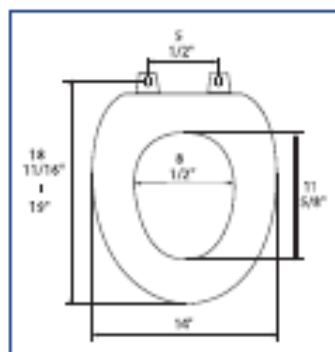

Residential

Model 126 - For ANSI Standard Elongated Toilets

Style: Closed Front with Cover

Material: Molded Wood (wood flour and resin)

Hinge: Extra Heavy Duty Plastic Hinge with Stainless Steel Screws and Pintels

Height of seat: 2 1/4"

Ring Thickness: 7/8"

Ring Thickness with Bumpers: 1 1/8"

PLUMBTECH™ molded wood seats utilize the finest paint to seal and beautify the molded wood core with deep lustrous color and rock hard enamel durability.