

# **Builder/Residential Molded Wood Slow Close Seats Designed for Fashion, Comfort, Luxury and Durability.**

by:

## **PLUMBTECH™**



**Model 144 Elongated**



**Model 143 Round**

**2**

*Two Year Limited Warranty!*

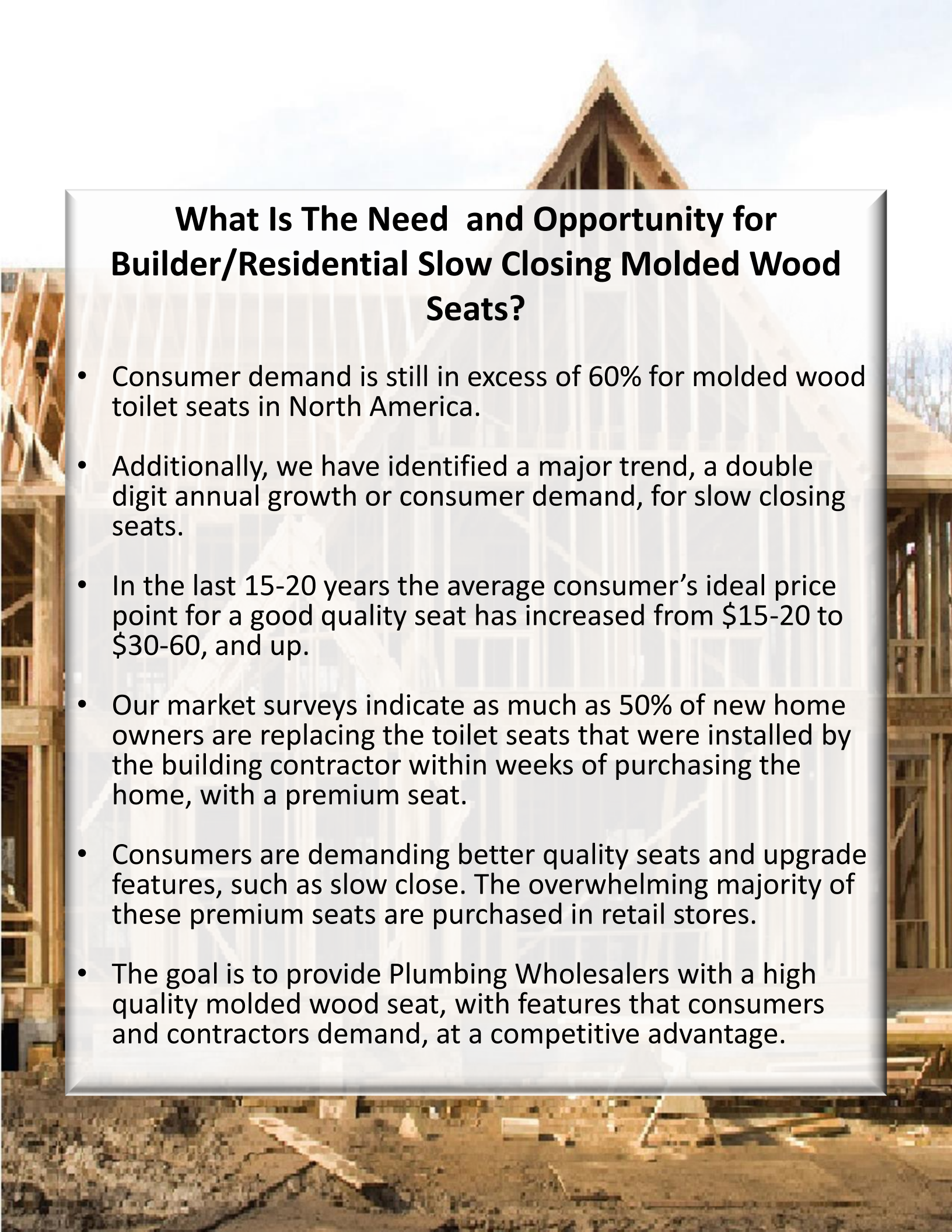

## **What Is The Need and Opportunity for Builder/Residential Slow Closing Molded Wood Seats?**

- Consumer demand is still in excess of 60% for molded wood toilet seats in North America.
- Additionally, we have identified a major trend, a double digit annual growth or consumer demand, for slow closing seats.
- In the last 15-20 years the average consumer's ideal price point for a good quality seat has increased from \$15-20 to \$30-60, and up.
- Our market surveys indicate as much as 50% of new home owners are replacing the toilet seats that were installed by the building contractor within weeks of purchasing the home, with a premium seat.
- Consumers are demanding better quality seats and upgrade features, such as slow close. The overwhelming majority of these premium seats are purchased in retail stores.
- The goal is to provide Plumbing Wholesalers with a high quality molded wood seat, with features that consumers and contractors demand, at a competitive advantage.



# PLUMBTECH™



PLUMBTECH Model 144-00  
Slow Close Elongated Molded  
Wood Seat.  
Suggested List: \$59.00



PLUMBTECH Model 143-00  
Slow Close Round Front  
Molded Wood Seat.  
Suggested List: \$55.00



**2**  
Two Year Limited Warranty!

## Features and Benefits of PLUMBTECH Models 143 & 144

- Patented, long life slow close damper system.
- Strong & Durable - Premium quality molded wood.
- Six layers of paint finish with sealer and primer.
- Maximum level of resins to create a rock hard wood core and extended life.
- Assembled with corrosion resistant stainless steel screws.
- Release 'N' Clean™ hinges for fast, easy installation and removal for cleaning.
- Vari-adjust™ with Lok-Down™ adjustable hinges for a perfect, secure fit on any standard ANSI toilet bowl.
- OSG - Odor Stain Guard ingredient in paint
- Ergonomically designed seat ring with contour provides greater comfort and support.
- Four bumpers on seat ring for extra stability.
- Heavy duty contractor grade hinge.
- Non-skid rubberized hinge pads.
- Corrosion proof Quik-Lok™ POM nuts, bolts and washers.
- Easy, self aligning, top mount installation with Quik Lok™ hardware.
- UV Ingredient to maintain color
- Meets and exceeds ANSI Quality Standards

*“Why pay the same or more, for less quality and features?”*

# Quik-Lok™



- UP TO 6X FASTER INSTALLATION!
- Save 50% to 80% in time-LABOR COST.
- Increased productivity - install in less than a minute.

 No tools necessary for installation!

**Simple Fast Easy**

# STA-PUT™



**Stop the Movement of Seats**



- Micro-suction cups inhibit the movement of wood toilet seats during normal use.
- Even minimizes the movement of the cover when the bathroom toilet is being used as a chair.



## Vari-Adjust™ with Lok-Down™ Adjustable Hinges and Release N Clean™



Compression  
“Dots” lock  
seat in place  
for added  
stability.



**Models 143 and 144 are available in White**

Plumbing Technologies LLC, [plumbtechseats.com](http://plumbtechseats.com)

Email: [customerservice@plumbtechseats.com](mailto:customerservice@plumbtechseats.com) Phone: 973-998-9778

Fax: 973-998-9780 or 973-947-6458

## RESIDENTIAL MOLDED WOOD Slow Close Seat



Factory-installed "living" hinge covers with stainless steel screws



Slow Close Seat

### Seat shall be PLUMBTECH™ MODEL - 143

- Patented slow close damper system
- Durable molded wood
- Multi-coat high gloss enamel paint with sealer and primer
- Vari Adjust hinge for the perfect fit
- Lok-Down mounting hardware to prevent loosening
- Release 'N' Clean hinge for ease of cleaning the toilet
- UV paint color protection
- Elongated closed front with cover
- Color coordinated bumpers
- Four bumpers on ring for stability
- Non-skid rubberized pads to minimize movement
- Assembled with corrosion resistant stainless steel screws
- Corrosion proof nuts and bolts
- Contractor grade heavy duty hinge
- Specify white -00

## PRODUCT SPECIFICATIONS

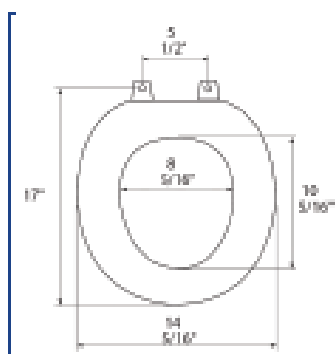

Residential

Model 143 - For ANSI Standard Round Front Toilets

Style: Closed Front with Cover

Material: Molded Wood (wood flour and resin)

Hinge: Heavy Duty Slow Close

Height of seat: 2 1/8"

Ring Thickness: 5/8"

Ring Thickness with Bumpers: 7/8"

PLUMBTECH™ molded wood seats utilize the finest paint to seal and beautify the molded wood core with deep lustrous color and rock hard enamel durability.



Factory-installed "living" hinge covers with stainless steel screws



Slow Close Seat

## RESIDENTIAL MOLDED WOOD

Slow Close Seat

### Seat shall be PLUMBTECH™ MODEL - 144

- Patented slow close damper system
- Durable molded wood
- Multi-coat high gloss enamel paint with sealer and primer
- Vari Adjust hinge for the perfect fit
- Lok-Down mounting hardware to prevent loosening
- Release 'N' Clean hinge for ease of cleaning the toilet
- UV paint color protection
- Elongated closed front with cover
- Color coordinated bumpers
- Four bumpers on ring for stability
- Non-skid rubberized pads to minimize movement
- Assembled with corrosion resistant stainless steel screws
- Corrosion proof nuts and bolts
- Contractor grade heavy duty hinge
- Specify white -00

## PRODUCT SPECIFICATIONS

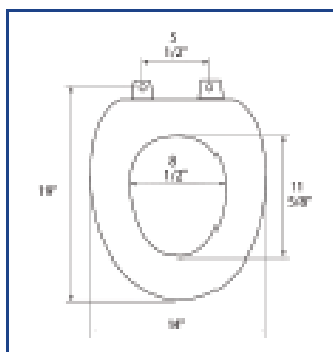

Residential

Model 144 - For ANSI Standard Elongated Toilets

Style: Closed Front with Cover

Material: Molded Wood (wood flour and resin)

Hinge: Heavy Duty Slow Close

Height of seat: 2 1/8"

Ring Thickness: 5/8"

Ring Thickness with Bumpers: 7/8"

PLUMBTECH™ molded wood seats utilize the finest paint to seal and beautify the molded wood core with deep lustrous color and rock hard enamel durability.