

**Premium Wood Slow Close Seats
designed for fashion, comfort,
luxury and durability.**

by:

PLUMBTECH™



Model 154 Elongated



Model 153 Round



What Is The Need and Opportunity for Premium Slow Closing Molded Wood Seats?

- Consumer demand is still in excess of 60% for molded wood toilet seats in North America.
- Additionally, we have identified a major trend, a double digit annual growth or consumer demand, for slow closing seats.
- In the last 15-20 years the average consumer's ideal price point for a good quality seat has increased from \$15-20 to \$30-40, and up.
- Our market surveys indicate as much as 50% of new home owners are replacing the toilet seats that were installed by the building contractor within weeks of purchasing the home, with a premium seat.
- Consumers are demanding better quality seats and upgrade features, such as slow close. The overwhelming majority of these premium seats are purchased in retail stores.
- The goal is to provide Plumbing Wholesalers with a premium molded wood seat, with features that consumers and contractors demand, at a competitive advantage.

PLUMBTECH™



PLUMBTECH Model 154-00
Premium Slow Close Elongated
Molded Wood Seat.
Suggested List: \$81.00



PLUMBTECH Model 153-00
Premium Slow Close Round
Front Molded Wood Seat.
Suggested List: \$75.00



3

Three Year Limited Warranty!

Features and Benefits of PLUMBTECH Models 153 & 154

- Patented, long life slow close damper system.
- Strong & Durable - Premium quality molded wood.
- Six layers of paint finish with sealer and primer.
- Maximum level of resins to create a rock hard wood core and extended life.
- Assembled with corrosion resistant stainless steel screws.
- Release 'N' Clean™ hinges for fast, easy installation and removal for cleaning.
- Vari-adjust™ with Lok-Down™ adjustable hinges for a perfect, secure fit on any standard ANSI toilet bowl.
- OSG - Odor Stain Guard ingredient in paint
- Ergonomically designed seat ring with contour provides greater comfort and support.
- Four bumpers on seat ring for extra stability.
- Heavy duty contractor grade hinge.
- Non-skid rubberized hinge pads.
- Corrosion proof Quik-Lok™ POM nuts, bolts and washers.
- Easy, self aligning, top mount installation with Quik Lok™ hardware.
- UV Ingredient to maintain color
- Meets and exceeds ANSI Quality Standards

“Why pay the same or more, for less quality and features?”

Quik-Lok™



- UP TO 6X FASTER INSTALLATION!
- Save 50% to 80% in time-LABOR COST.
- Increased productivity - install in less than a minute.

 No tools necessary for installation!

Simple Fast Easy

STA-PUT™



Stop the Movement of Seats



- Micro-suction cups inhibit the movement of wood toilet seats during normal use.
- Even minimizes the movement of the cover when the bathroom toilet is being used as a chair.

Vari-Adjust™ with Lok-Down™ Adjustable Hinges and Release N Clean™



Compression “Dots” lock seat in place for added stability.

Models 153 and 154 are available in White, Bone, Linen and Black

Also available in chrome finish hinges, round and elongated, models 1C3R6-00CH and 1C3E6-00CH



Plumbing Technologies LLC, plumbtechseats.com

Email: customerservice@plumbtechseats.com Phone: 973-998-9778

Fax: 973-998-9780 or 973-947-6458

RESIDENTIAL MOLDED WOOD

Factory-installed "living"
hinge covers with stainless
steel screws



Slow Close Seat

**Seat shall be PLUMBTECH™
MODEL - 153**

- Patented slow close damper system
- Durable molded wood
- Multi-coat high gloss enamel paint with sealer and primer
- UV paint color protection
- Round closed front with cover
- OSG - Odor Stain Guard ingredient in paint
- Color coordinated bumpers
- Four bumpers on ring for stability
- Non-skid rubberized pads
- Assembled with corrosion resistant stainless steel screws
- Corrosion proof nuts and bolts
- Contractor grade heavy duty hinge
- Specify white -00, bone -01 or biscuit -02

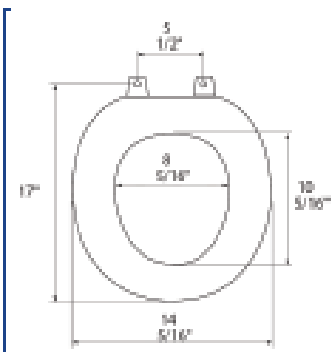
PRODUCT SPECIFICATIONS

Residential

Model 153 - For ANSI Standard Round Front Toilets

Style: Closed Front with Cover

Material: Molded Wood (wood flour and resin)

Hinge: Heavy Duty Slow Close

Height of seat:

Ring Thickness:

Ring Thickness with Bumpers:

PLUMBTECH™ molded wood seats utilize the finest paint to seal and beautify the molded wood core with deep lustrous color and rock hard enamel durability.

RESIDENTIAL MOLDED WOOD

Seat shall be PLUMBTECH™ MODEL - 154

- Patented slow close damper system
- Durable molded wood
- Multi-coat high gloss enamel paint with sealer and primer
- UV paint color protection
- Elongated closed front with cover
- OSG - Odor Stain Guard ingredient in paint
- Color coordinated bumpers
- Four bumpers on ring for stability
- Non-skid rubberized pads
- Assembled with corrosion resistant stainless steel screws
- Corrosion proof nuts and bolts
- Contractor grade heavy duty hinge
- Specify white -00, bone -01 or biscuit -02



Factory-installed "living" hinge covers with stainless steel screws



Slow Close Seat

Quik-Lok™ No Tools Required

Release 'N' Clean™ Hinges



Available in BathDécor™ package - Model 1C3E6

PRODUCT SPECIFICATIONS

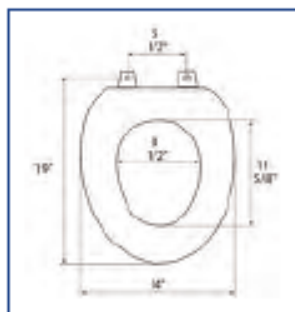

Residential

Model 154 - For ANSI Standard Elongated Toilets

Style: Closed Front with Cover

Material: Molded Wood (wood flour and resin)

Hinge: Heavy Duty Slow Close

Height of seat:

Ring Thickness:

Ring Thickness with Bumpers:

PLUMBTECH™ molded wood seats utilize the finest paint to seal and beautify the molded wood core with deep lustrous color and rock hard enamel durability.