

Premium Heavy Duty Plastic Seats for Commercial and Residential Applications

by:

PLUMBTECH™



Model 231 Elongated



Model 230 Round



What are the Needs and Opportunity for Premium Heavy Duty Commercial Quality Seats?

- The hospitality and light duty commercial market has a need for heavy duty seats that are highly durable, stylish modern design, easy to install and maintain, and are budget friendly.
- Upscale consumers are also looking for the same features in premium quality heavy duty seats that are highly durable, stylish modern design, easy to install and maintain, and are budget friendly.
- With the introduction of slow close seat models some seat manufacturers or distributors exited the heavy duty residential plastic seat market for the more expensive heavy duty slow close market with much higher cost.
- There are still a lot of professional applications or installations where the requirement is for a heavy duty toilet seat at a reasonable price.
- There are both professional installers and commercial customers who prefer to meet the the minimum requirement versus adding more cost.

PLUMBTECH™



PLUMBTECH Model 231-00.
Elongated Plastic
Suggested List: \$90.00



PLUMBTECH Model 230-00.
Round Front Plastic
Suggested List: \$85.00



3

Three Year Limited Warranty!

Features and Benefits of PLUMBTECH Premium Heavy Duty Commercial Seat Models 230 & 231

- **Constructed of 100% virgin polypropylene-no fillers, extenders, or regrind.**
- **Strong & Durable - injection molded, high impact, chemically resistant.**
- **Ergonomically designed seat ring with contour provides greater comfort and support.**
- **Specially designed cover resists flexing, or “oil canning”.**
- **Very thick profile and heavy weight for extra durability and long service life.**
- **Release-N-Clean™ hinge for easy mounting and cleaning.**
- **Corrosion proof Quik-Lok™ POM nuts, bolts and washers.**
- **Adjustable hinges for a perfect fit on any standard ANSI toilet bowl.**
- **Heavy Duty Contractor Hinge.**
- **Molded in bumpers for added safety and comfort.**
- **Easy, self aligning, top mount installation with Quik-Lok™ hardware.**
- **UV Ingredient to maintain color**
- **Meets and exceeds ANSI Quality Standards**

“Why pay the same or more, for less quality and features?”

Quik-Lok™



- UP TO 6X FASTER INSTALLATION!
- Save 50% to 80% of your time-LABOR COST.
- Increased productivity - install in less than a minute.

 No tools necessary for installation!

Simple Fast Easy

Vari-Adjust™ with Lok-Down™ Adjustable Hinges and Release N Clean™



Compression “Dots” lock seat in place for added stability.

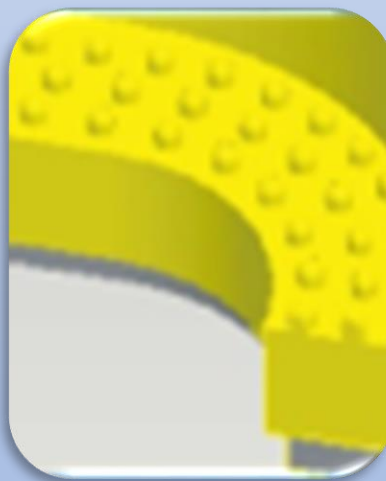

Models 230 and 231 are available in White, Bone and Linen

Plumbing Technologies LLC, plumbtechseats.com
Email: customerservice@plumbtechseats.com Phone: 973-998-9778
Fax: 973-998-9780 or 973-947-6458

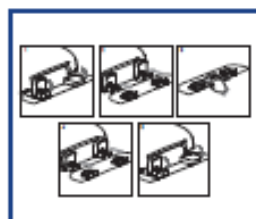
RESIDENTIAL PLASTIC

Release 'N' Clean™

Factory-installed "living"
hinge covers**Seat shall be PLUMBTECH™
MODEL - 230**

- Round closed front with cover
- Premium residential design
- Injection molded durable polypropylene plastic with UV protection
- Molded in bumpers
- Contractor quality matching Release 'N' Clean™ adjustable hinge
- Stainless steel pintel for durability
- Non-skid rubberized pads
- Corrosion proof POM nuts, bolts and washers
- Top mount design
- Accepts 304 stainless steel 200HPSS mounting hardware
- Specify white -00, bone -01 or biscuit -02

White available in BathDécor™ package - Model 2C3R3

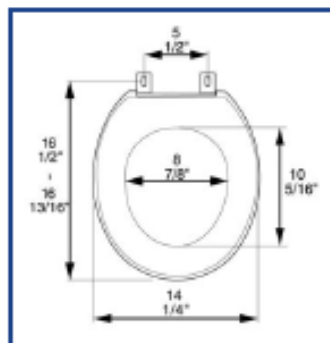
PRODUCT SPECIFICATIONS**Residential****Model 230 - For ANSI Standard Round Front Toilets****Style: Closed Front with Cover****Material: Polypropylene Plastic****Hinge: Release 'N' Clean™ adjustable hinge****Height of seat: 2"****Ring Thickness: 5/8"****Ring Thickness with Bumpers: 1"****PLUMBTECH™ plastic seats utilize high grade virgin polypropylene plastic.
Complies with ANSI Standard Z124.5 Section 5.1.2**

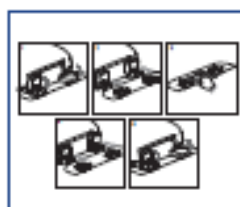
RESIDENTIAL PLASTIC

Release 'N' Clean™

Factory-installed "living"
hinge covers**Seat shall be PLUMBTECH™
MODEL - 231**

- Elongated closed front with cover
- Premium residential design
- Injection molded durable polypropylene plastic with UV protection
- Molded in bumpers
- Contractor quality matching Release 'N' Clean™ adjustable hinge
- Stainless steel pintel for durability
- Non-skid rubberized pads
- Corrosion proof POM nuts, bolts and washers
- Top mount design
- Accepts 304 stainless steel 200HPSS mounting hardware
- Specify white -00, bone -01 or biscuit -02

White available in BathDécor™ package - Model 2C3E3

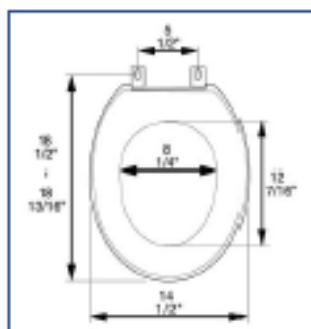
PRODUCT SPECIFICATIONS**Residential****Model 231 - For ANSI Standard Elongated Toilets****Style: Closed Front with Cover****Material: Polypropylene Plastic****Hinge: Release 'N' Clean™ adjustable hinge****Height of seat: 2"****Ring Thickness: 5/8"****Ring Thickness with Bumpers: 1"**

PLUMBTECH™ plastic seats utilize high grade virgin polypropylene plastic.
Complies with ANSI Standard Z124.5 Section 5.1.2