

**Plastic Seat Designed for Residential,
Remodel and Multi-Family Applications**

by:

PLUMBTECH™



Model 223 Elongated

What Is The Need and Opportunity for New Deluxe Plastic Seats?

- The residential market is always evolving and searching for ways and means to bend the cost curve while maintaining the overall quality of the final product.
- Additionally, consumers and homeowners are more conscious than ever regarding extra styling and new features.
- Our market surveys indicate as much as 50% of new homeowners are replacing the toilet seats, installed by the building contractor within weeks of purchasing the home.
- The overwhelming majority of new residential construction toilet seats are being replaced by new homeowners with better quality seats and upgrade features. The overwhelming majority of these seats are purchased in retail stores.
- It became clear that one of our goals had to be filling the need for an upgrade quality plastic seat, with premium features, without the premium price.
- The second goal had to be to design, engineer and manufacture a plastic seat that meets the needs of contractors and consumers

PLUMBTECH™



PLUMBTECH Model 223.
Elongated Plastic
Suggested List: \$25.00



2

Two Year Limited Warranty!

Features and Benefits of PLUMBTECH Deluxe Plastic Model 223

- **Constructed of 100% virgin polypropylene-no fillers, extenders, or regrind.**
- **Strong & Durable - injection molded, high impact, chemically resistant.**
- **Ergonomically designed seat ring with contour provides greater comfort and support.**
- **Specially designed cover resists flexing, or “oil canning**
- **Release-N-Clean™ hinge for easy mounting and cleaning.**
- **Corrosion proof Quik-Lok™ POM nuts, bolts and washers.**
- **Adjustable hinges for a perfect fit on any standard ANSI toilet bowl.**
- **Heavy Duty Contractor Hinge.**
- **Molded in bumpers for added safety and comfort.**
- **Easy, self aligning, top mount installation with Quik-Lok™ hardware.**
- **UV Ingredient to maintain color**
- **Meets and exceeds ANSI Quality Standards**

“Why pay the same or more, for less quality and features?”

Quik-Lok™



- UP TO 6X FASTER INSTALLATION!
- Save 50% to 80% of your time-LABOR COST.
- Increased productivity - install in less than a minute.

 No tools necessary for installation!

Simple Fast Easy

Vari-Adjust™ with Lok-Down™ Adjustable Hinges and Release N Clean™



Compression “Dots” lock seat in place for added stability.

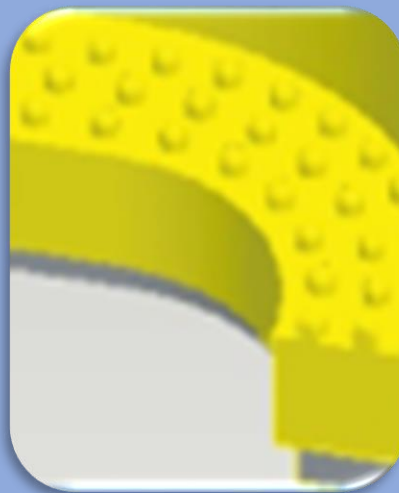

Model 223 is available in Bone and Biscuit/Linen.

Plumbing Technologies LLC, plumbtechseats.com
Email: customerservice@plumbtechseats.com Phone: 973-998-9778
Fax: 973-998-9780 or 973-947-6458

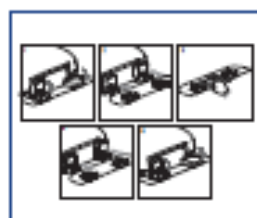
RESIDENTIAL PLASTIC

Release 'N' Clean™

**Seat shall be PLUMBTECH™
MODEL - 223**

- Deluxe grade residential elongated closed front with cover
- Heavy duty contractor grade Release 'N' Clean™ hinge with Vari-Adjust Lok-Down™
- Injection molded durable polypropylene plastic with UV protection
- Molded in bumpers
- Built in non-skid rubberized pad
- Corrosion proof POM nuts, bolts and washers
- Compact profile design to list on any ANSI standard toilet
- Top mount design for ease of installation
- Accepts 304 stainless steel 200HPSS mounting hardware
- Specify white -00

White available in BathDécor™ package - Model 2C5E2

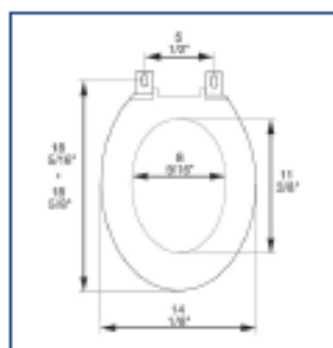
PRODUCT SPECIFICATIONS**Residential****Model 223 - For ANSI Standard Elongated Toilets****Style: Closed Front with Cover****Material: Polypropylene Plastic****Hinge: Contractor Quality Heavy Duty Plastic Hinge****Height of seat: 1 3/8"****Ring Thickness: 5/8"****Ring Thickness with Bumpers: 3/4"****PLUMBTECH™ plastic seats utilize high grade virgin polypropylene plastic.
Complies with ANSI Standard Z124.5 Section 5.1.2**